

AviLow Subwoofer



- **A series family - Lightweight**
- **Touring - Fixed installation**
- **Deployment in Vertical and Horizontal**
- **VDA18/ VDA12 Controller / Avi**

The system shall consist of a high power subwoofer driven and protected by a dedicated amplified controller.

The enclosure shall feature 1 x 12" LF Ferrite drivers in a bass-reflex tuned enclosure with L-Vents. The long term AES handling power shall be 500W at the nominal 8Ω impedance.

The low frequency limit shall be 40Hz. Maximum SPL shall be 134dB. Enclosure cabinet construction shall be made from first grade Baltic beech and birch plywood. The dimensions shall be Width:350mm Height:400mm Depth:400mm. The front of the enclosure shall be protected by a steel grill with anti-corrosion coating covered with acoustically neutral 3D fabric. Finish shall be available in dark grey brown pure Enclosure weight shall be 16kg.

Compatible base plate and two anti-vibration mats shall allow safe ground-stacking of the enclosure. The subwoofer shall be connected via a 4-point speakON connector.

Angel Low Technical Specification

Type	Subwoofer
Amplifier Recommend	VDA12
Frequency Response(Preset)	40Hz - 200Hz(-6dB)
Horizontal	360°
Drivers	LF: 1x12" (Ferrite)
Handling Power (AES)	LF:500W
Maximum Peak SPL	134dB/1m
Nominal Impedance	LF: 8Ω
Connectors	2 x NL4 SpeakOn
Pin Connectors	IN = LF:+1-1 IN = MF/ HF +2-2
Height Front	400mm
Height Back	400mm
Width	350mm
Depth	400mm
Weight	16kg / 35.3lb
Handle	2 ergonomic handles
Threaded	4x M6 threaded insert
Pole socket	1x 35mm Pole socket
Material	Baltic Birch Plywood
Finish	Dark Grey
Front	Polyester powder-coated steel grill
Rigging	Steel
Protection rating	IP45



Front

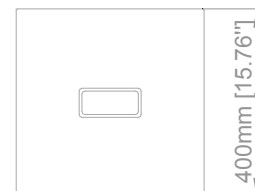

Side

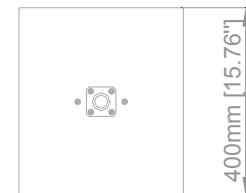

Top

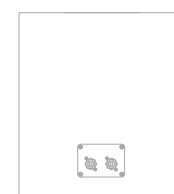

Rear